

- 1 Church of Mary Theotokos
- 2 Monastery and bathhouse
- 3 Residential building and oil press (Area T)
- 4 Monumental staircase leading to the sacred precinct
- 5 Lower gatehouse
- 6 Courtyards for pilgrims' accommodation
- 7 Citadel
- 8 "The Twelve Stones"
- 9 Fortified enclosure
- 10 Western entrance to the sacred precinct
- 11 "Everlasting Hill"
- 12 Winepress
- 13 "Altar of the Sacrifice of Isaac"
- 14 Public building
- 15 Mansion (Area P)
- 16 Southwestern residential quarter (Area A)
- 17 Mansion (Area E)
- 18 Southern residential quarter (Area B)
- 19 Southern city-gate
- 20 Southern city-wall
- 21 Citadel — public building
- 22 Residential building (Area K2)
- 23 Residential building (Area K1)

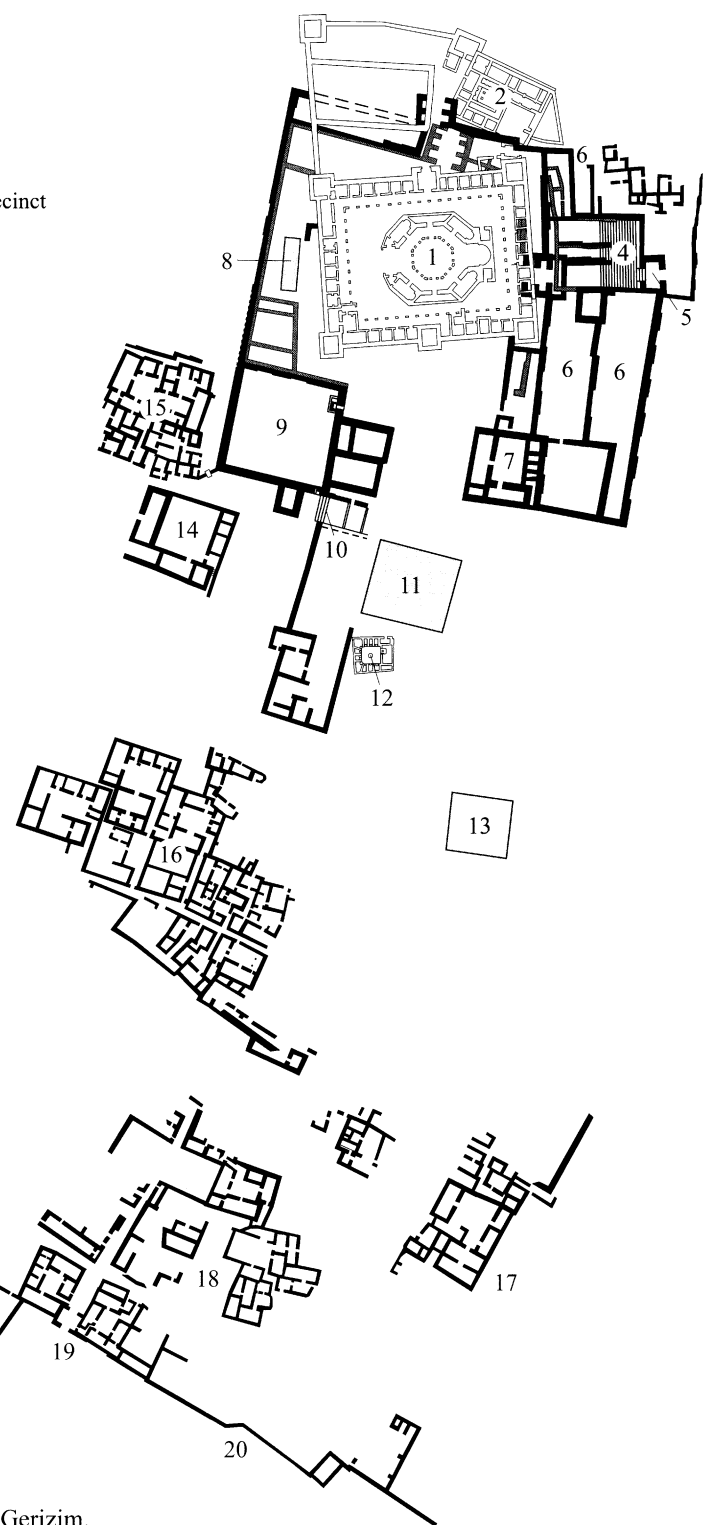

- Persian period
- Hellenistic period
- Byzantine period
- Samaritan holy place

0 50 m

Fig. 2. Schematic plan of the excavations at Mt. Gerizim.